

# iléktró

## Woodland Electric Fire

### USER INSTRUCTIONS AND INSTALLATION MANUAL



Version 1 17/09/25

Contents of manual may be updated without notice.

For the latest version of this manual please refer to our website: [www.paulagnewdesigns.com.au](http://www.paulagnewdesigns.com.au)

Fig. 1. Electric Stove

#### **IMPORTANT NOTE**

THE HEATER OUTLET GRILL BECOMES VERY HOT WHILST IN OPERATION. DO NOT COVER THE OUTLET GRILL OR ANY PART OF THE APPLIANCE. FOR USE WITH 220V - 240V 60HZ ELECTRICITY SUPPLY ONLY. PLEASE READ THESE INSTRUCTIONS CAREFULLY BEFORE INSTALLATION KEEP THE INSTRUCTIONS IN A SAFE PLACE.THEY WILL BE NEEDED WHEN MAINTENANCE OR SERVICING IS REQUIRED. THIS APPLIANCE MUST BE EARTHED.

# USER MANUAL CONTENTS

BOX CONTENTS	3
HOW TO USE YOUR APPLIANCE	
1. IMPORTANT SAFETY INFORMATION	4
2. GENERAL INSTALLATION	6
3. ELECTRIC STOVE INSTALLTION	7
4. LOG INSTALLATION	8
5. OPERATION	10
6. APP CONNECTION INSTRUCTIONS	14
7. CARE AND MAINTENANCE	18
8. TROUBLESHOOTING	21
REFERENCE INFORMATION	
11. GENERAL INFORMATION	23
11. WIRING DIAGRAM	24
12. EXPLODED DIAGRAM	25

## TERMS AND CONDITIONS WARRANTY

EUROSTOVE LTD UNIT H1

MENDIP INDUSTRIAL ESTATE  
ROOKSBRIDGE SOMERSET BS26 2UG

FULL TERMS AND CONDITIONS ARE DETAILED  
IN THE WARRANTY STATEMENT ON THE  
WEBSITE [WWW.PAULAGNEWDESIGNS.COM.AU](http://WWW.PAULAGNEWDESIGNS.COM.AU).

IN THE EVENT OF ANY CONFLICT OF  
INFORMATION THE WORDING ON THE WEBSITE  
SHALL PREVAIL. IMPORTANT NOTE: SHOULD  
ANY PROBLEMS BE EXPERIENCED WITH YOUR  
PRODUCT, CLAIMS MUST FIRST BE SUBMITTED  
TO THE RETAILER WHERE THE APPLIANCE  
WAS PURCHASED FROM WHO WILL OFFER  
IMMEDIATE ASSISTANCE.

REGISTRATION NUMBER:  
IN ACCORDANCE WITH EUROPEAN DIRECTIVE  
2012/19/ EU, WASTE ELECTRICAL AND  
ELECTRONIC EQUIPMENT (WEEE) MUST NOT  
BE DISPOSED OF WITH HOUSEHOLD WASTE.  
AT THE END OF ITS USEFUL LIFE PLEASE TAKE  
THIS PRODUCT TO AN APPROPRIATE  
RECYCLING CENTRE OR COLLECTION POINT.

YOU CAN FIND  
YOUR NEAREST RECYCLING CENTRE BY USING  
THE BANK LOCATOR AT  
[WWW.RECYCLE-MORE.CO.UK](http://WWW.RECYCLE-MORE.CO.UK) FOR UK  
CUSTOMERS,  
[WWW.ACOR.ORG.AU](http://WWW.ACOR.ORG.AU) FOR AUSTRALIA  
CUSTOMERS  
[WWW.WEEEIRELAND.IE](http://WWW.WEEEIRELAND.IE) FOR CUSTOMERS  
IN THE REPUBLIC OF IRELAND, OR BY  
CONTACTING YOUR LOCAL AUTHORITY



## BOX CONTENTS

PLEASE CHECK THAT THE FOLLOWING COMPONENTS ARE INCLUDED WITHIN THE BOX. IF ANYTHING IS MISSING OR DAMAGED, PLEASE CONTACT THE RETAILER AND DO NOT USE THE APPIANCE UNTIL YOU HAVE EVERYTHING.

- ☒ APPLIANCE WITH TRAILING LEAD WITH MOULDED 13AMP
- ☒ PLUG REMOTE CONTROLHANDSET AND BATTERIES
- ☒ BLACK COAL
- ☒ INSTRUCTION MANUAL
- ☒ LOG SET
- ☒ CRYSTALS



## 1. IMPORTANT SAFETY INFORMATION!

### WARNING

When using electrical appliances basic precautions should always be followed to reduce the risk of fire, electric shock and injury to persons, including the following:

- Read all instructions before using this heater.
- This heater is hot when in use. To avoid burning, do not touch hot surface. If provided, use handles when moving this heater. Keep combustible materials, such as furniture, pillows, bedding, papers, clothes, and curtains at least 1 m from the front of the heater and keep them away from the sides and rear. In order to avoid overheating, do not cover the heater.
- Extreme caution is necessary when any heater is used near children or the infirm and whenever the heater is left operating and unattended.
- If leaving for an extended period, it is suggested that you turn the power off to the unit.
- Do not operate any heater with a damaged cord or plug or after the heater malfunctions, has been dropped damaged in any manner, return heater to authorized service facility for examination, electrical or mechanical adjustment, or repair.
- Indoor use only, do not use outdoors.
- This heater is not intended for use in bathrooms, laundry areas and similar indoor locations. Never locate heater where it may fall into a bathtub or other water container.
- Do not run cord under carpeting. Do not cover cord with throw rugs, runners, or similar coverings. Arrange cord away from traffic area and where it will not be tipped over.
- To disconnect heater, turn controls to off, then remove plug from outlet.
- Do not insert or allow foreign objects to enter any ventilation or exhaust opening as this may cause an electric shock or fire, or damage the heater.
- To prevent a possible fire, do not block air intakes or exhaust in any manner. Do not use on soft surfaces, like a bed, where openings may become blocked.
- A heater has hot and arcing or sparking parts inside. Do not use it in areas where gasoline, or flammable liquids are used or stored.
- Use this heater only as describes in this manual. Any other use not recommended by the manufacturer may cause fire, electric shock, or injury to persons.
- DANGER-HIGH Temperatures may be generated under certain abnormal conditions. Do not partially or fully cover or obstruct the front of this heater.
- Replacement of the lamps should be done only while the heater is disconnected from the supply circuit.
- This appliance is not intended for use by persons (including children) with reduced physical, sensory or capabilities, or lack of experience and knowledge, unless they have been given supervision or instruction concerning use of the appliance by a person responsible for their safety. Children should be supervised to ensure that they do not play with the appliance.
- CAUTION: In order to avoid a hazard due to inadvertent resetting of the thermal cut-out, this appliance must not be supplied through an external switching device, such as a timer, or connected to a circuit that is regularly switched on and off by the utility.
- Never use aerosols or steam cleaners near this product.
- If the electricity supply cable is damaged do not use the appliance until it has been replaced. Replacement must be carried out by a service agent or a similarly competent electrician.
- If the electricity supply cable is damaged do not use the appliance until it has been replaced. Replacement must be carried out by a service agent or a similarly competent electrician.

**WARNING**

- In order to avoid a hazard due to inadvertent resetting of the thermal cut out, this appliance must not be supplied through an external switching device, such as a timer, or connected to a circuit that is regularly switched on and off by the utility.
- Some parts of this product can become very hot and cause burns, particular attention must be given where children and vulnerable people are present.
- Children aged from 3 years to less than 8 years shall only switch on/off the appliance provided that it has been placed or installed in its intended normal operating position and they have been given supervision or instruction concerning the use of the appliance in a safe way and understand the hazards involved. Children aged from 3 years and less than 8 years shall not plug in, regulate and clean the appliance or perform user maintenance.

## 2. GENERAL INSTALLATION

### HOW TO INSTALL YOUR APPLIANCE:

NOTE: INSTALLATION SHOULD BE CARRIED OUT BY A TRAINED INSTALLATION TECHNICIAN. **IF THE PRODUCT IS INSTALLED INCORRECTLY YOUR WARRANTY MAY BE INVALID.**

IT IS VERY IMPORTANT THAT THE AIR INLET GRILLES ON THE BOTTOM/UNDER THE APPLIANCE ARE UNOBSTRUCTED AND ADEQUATE SPACE IS LEFT TO ALLOW FREE CIRCULATION OF AIR AROUND THIS AREA.

### UNPACKING THE FIREPLACE

WARNING! DO NOT USE THIS APPLIANCE IF ANY PART HAS BEEN EXPOSED TO WATER. IMMEDIATELY CALL A QUALIFIED SERVICE TECHNICIAN TO INSPECT AND TO REPLACE ANY PART OF THE ELECTRICAL SYSTEM IF NECESSARY.

- CAREFULLY UNPACK THE APPLIANCE. TAKE CARE NOT TO DAMAGE THE SURFACE OF THE APPLIANCE OR THE INSTALLATION AREA. KEEP PLASTIC WRAPPING AWAY FROM CHILDREN. BE RESPONSIBLE WHEN HANDLING THE PACKING MATERIALS.
- CHECK ALL PARTS AND ACCESSORIES ARE REMOVED BEFORE DISPOSING OF ANY PACKAGING.
- IF NECESSARY, KEEP THE ORIGINAL PACKAGING FOR FUTURE TRANSPORT AND/OR STORAGE.

### FITTING THE APPLIANCE

TAKE CARE WHEN LIFTING THE APPLIANCE, OBTAIN ASSISTANCE IF REQUIRED AND ALWAYS FOLLOW SAFE MANUAL HANDLING TECHNIQUES.

WHEN IN DOUBT CONSULT YOUR RETAILER OR SUITABLY QUALIFIED PERSON.

### INSTALLATION OPTIONS

PLEASE DISCUSS THIS WITH YOUR RETAILER  
IF YOU ARE IN DOUBT WHICH INSTALLATION OPTION IS RIGHT FOR YOU CONTACT YOUR RETAILER.



### 3. ELECTRIC STOVE

#### INSTALLATION

#### TECHNICAL SPECIFICATION:

MODEL		ELECTRIC STOVE
WEIGHT KG		50
VOLTAGE		220-240V AC ~50-60HZ
BATTERY HANDSET		12V MN 21/23
TRANSMITTER ELECTRICAL POWER CONSUMPTION	FLAME PICTURE ONLY	8W
	HEATING ON	2000 WATT
SUPPLY CORD	UK	BS1363 UK13A
	AUSTRALIAN	AS/NZS3112
	EUROPEAN	VDE 0620

THIS APPLIANCE MUST BE EARTHED.

THIS APPLIANCE HAS BEEN CERTIFIED FOR USE IN COUNTRIES OTHER THAN THOSE STATED. TO INSTALL THIS APPLIANCE IN THESE COUNTRIES, IT IS ESSENTIAL TO OBTAIN THE TRANSLATED INSTRUCTIONS AND IN SOME CASES THE APPLIANCE WILL REQUIRE MODIFICATION. CONTACT YOUR RETAILER FOR FURTHER INFORMATION.

FOR PRODUCT DIMENSIONS AND INSTALLATION GUIDES FOR BUILDING YOU APPLIANCE INTO A LOCATION, PLEASE GO TO WEBSITE: [PAULAGNEWDESIGNS.COM.AU](http://PAULAGNEWDESIGNS.COM.AU). TO DOWNLOAD THE SPEC SHEET FOR YOUR APPLIANCE.

WEIGHTS UNIT ONLY NOT INCLUDING PACKAGING SUITE APPLIANCE (S) WEIGHTS ARE NOT INCLUDING WOODEN SURROUND.

#### ELECTRICAL CONNECTION:

ENSURE THE APPLIANCE IS FULLY ASSEMBLED AND THE FRONT GLASS WITH TRIM IS BACK IN THE APPLIANCE BEFORE THE APPLIANCE IS CONNECTED TO MAINS POWER

#### CONNECTING TO MAIN SUPPLY:

- CHECK WHETHER THE MAIN SUPPLY CAN ACCOMMODATE THE ADDITIONAL LOAD OF 1000 OR 2000 WATT
- CONNECT THE POWER CABLE TO AN EARTHED SOCKET
- ONLY USE THE POWER CABLE PROVIDED WITH YOUR APPLIANCE AS IT WILL BE CORRECT FOR YOUR REGION

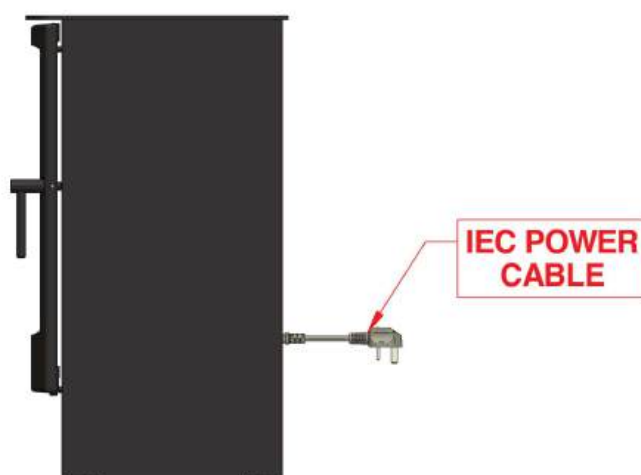

Fig. 2. IEC Power Cable

- YOUR NEW APPLIANCE MAY BE INSTALLED VIRTUALLY ANYWHERE IN YOUR HOME. HOWEVER, WHEN CHOOSING A LOCATION ENSURE THAT THE GENERAL INSTRUCTIONS ARE FOLLOWED.
- IF THE POWER CORD IS DAMAGED, IT MUST BE REPAIRED BY THE MANUFACTURER, ITS AUTHORIZED SERVICE CENTRE OR PROFESSIONAL PERSON.
- ENSURE THAT CURTAINS AND FURNITURE ARE NOT POSITIONED CLOSE TO THE CHOSEN POSITION, AS THIS WOULD CREATE A POTENTIAL FIRE HAZARD OR BLOCK THE HEATER OUTLET DUCTS. FOR BEST RESULTS, INSTALL OUT OF DIRECT
- THE APPLIANCE SHOULD IDEALLY BE LOCATED CLOSE TO A SUITABLE MAINS SOCKET TO ENABLE CONNECTION. THE ELECTRICAL SOCKET MUST BE EASILY ACCESSIBLE TO ALLOW DISCONNECTION WHEN THE APPLIANCE IS FITTED.
- WARNING! IF THE ELECTRICAL SOCKET IS NOT ACCESSIBLE ONCE THE APPLIANCE HAS BEEN INSTALLED THEN A QUALIFIED ELECTRICIAN WILL NEED TO INSTALL AN ISOLATION SWITCH.
- WARNING! KEEP ANY FURNISHINGS OR COMBUSTIBLE MATERIALS AT LEAST 1m FROM THE FRONT OF THE ELECTRIC FIREPLACE.

## 4. FUEL BED SET UP

CAUTION CERAMIC LOG SETS ARE DELICATE. TAKE CARE WHEN HANDLING. REFER TO REFER TO FOLLOWING PAGE FOR FUEL BED ITEMS.

- STEP 1  
SPREAD AMBER CRYSTALS ON FUEL BED.
- STEP 2  
PLACE LOG AND DRIFT WOOD, WITH TWO DRIFT BRANCHES WITH WIRE BODIES THAT NEED TO BE THREADED THROUGH THE WIRE HOLES OF THE CHARCOAL FIRE FIRST AND THEN INSERT THE PLUG OF THE WIRE BODY INTO THE PORT ON THE PRODUCT.
- STEP 3  
POSITION CERAMIC LOG AS PER THE DIAGRAM AS SHOWN BELOW. RANDOMLY STACK AND OVERLAY LOGS AGAINST EACH OTHER.
- STEP 4  
DISTRIBUTE THE BLACK CRYSTALS EVENLY ACROSS THE FUEL BED.
- STEP 5  
DISTRIBUTE THE COALS CHIPS EVENLY ACROSS THE FUEL BED.



Fig. 3. Log Arrangement





This product includes a GLASS panel ! Always use extreme caution when handling glass. Failure to do so could result in personal injury or property damage.

Remove all parts and hardware from the carton and place them on a clean, soft, dry surface. Parts and assembly steps are grouped for wall-hanging or recessing use. Check the parts list to make sure nothing is missing. Dispose of packaging materials properly. Please recycle whenever possible.

You will need the following tools (not included): Phillips screwdriver; stud finder; level; tape measure; electric drill; 1/4" wood drill bit, hammer.

Fireplace



Fig. 4.

Black Crystals



Fig. 5.

Black Coal Chips



Fig. 6.

Grey and Red Crystals



Fig. 7.

Remote Control



Fig. 8.

Log Set



Fig. 9.

## 5. OPERATION



Read and understand this entire owner's manual, including all safety information, before plugging in or using this product. Failure to do so could result in electric shock, fire and serious injury.

### Methods of Operation

This electric fireplace can be operated by the CONTROL PANEL, located on the upper left side of the back of the fireplace (see below image).

This unit can be operated by supplied remote control only.

Before operating, please review the IMPORTANT SAFETY INFORMATION on Page 4, and heed all warnings.

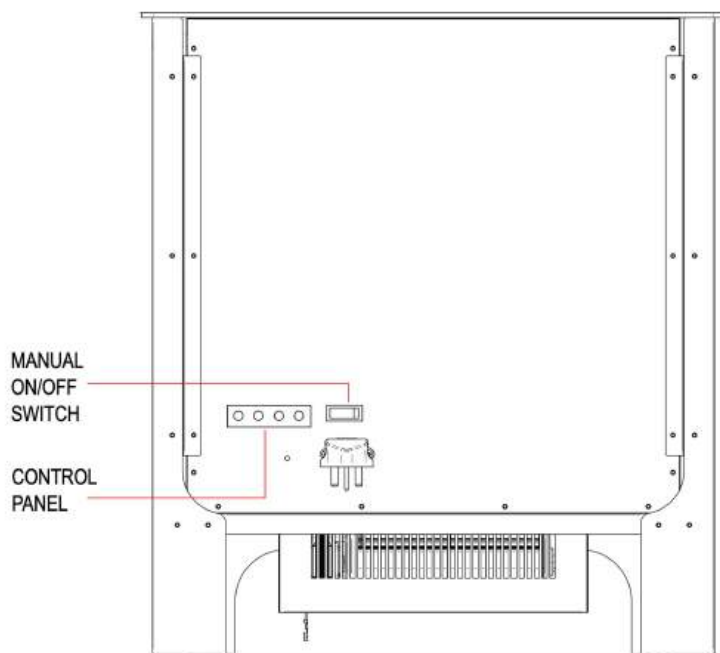

#### NOTE:

THE UNIT CAN BE OPERATED BY SUPPLIED REMOTE CONTROL ONLY. FOR THE UNIT TO OPERATE, THE MANUAL ON/OFF SWITCH, LOCATED ON THE REAR TOP RIGHTSIDE OF THE FIREPLACE MUST BE SWITCHED TO THE "I" POSITION.

FAULT: THE HEATING DOES NOT TURN-ON WHEN YOU SELECT HEATING MODE BUT THE FLAME EFFECT IS RUNNING.





A) CHECK THE BATTERIES IN YOUR HAND SET. THE RED LED MUST BE SHOWING BRIGHTLY.

B) TRY SELECTING HEATING MODE AGAIN, BUT CLOSER TO THE APPLIANCE.

C). TURN OFF APPLIANCE, THEN TURN IT ON AGAIN. WAIT FOR 10 SECONDS, THEN SELECT HEATING MODE AGAIN.

Fig. 10. Electric Stove Back View

## Control Panel Operation

BUTTON	FUNCTION	ACTION & INDICATION
	POWER	Turns the fireplace on/off.
	FLAME COLOR	Orange, red, yellow, orange-red, orange-yellow.
	HEATING	Turns the heater on/off. Settings: HO-Heater off H1-Low heat H2-High heat
	SOUND EFFECTS	Turns the volume on/off.

The control panel is found on the back of the fireplace, near the on/off switch.







Fig. 11. Electric Stove Remote Control

## NOTICE

When the fireplace is first turned on, a slight odor may be present. This is normal and should not occur again unless the heater is not used for a long period of time.

## NOTICE

To improve operation, aim the remote control at the front of the fireplace. DO NOT press the buttons too quickly. Give the unit time to respond to each command.

## Temperature Limiting Control

This heater is equipped with a Temperature Limiting Control. Should the fireplace reach an unsafe temperature, the fireplace will automatically turn OFF. To reset, review the following page.

1. Unplug the power cord from the outlet.
2. Turn the ON/OFF switch on the CONTROL PANEL to OFF. Wait 5 minutes.
3. Inspect the fireplace to make sure no vents are blocked, or clogged with dust or lint. If they are, use a vacuum to clean the vent areas.
4. With the POWER switch in the OFF position, plug the power cord back into the outlet.
5. If the problem continues, have your outlet and wiring inspected by a professional.

## Thermal Safety Cut Out

If the safety cut out for the heater trips, the appliance has overheated. If this happens:

1. Switch off the device from the isolation switch and allow it to cool down for a minimum of 2 hours.
2. Check the heater outlet vents for any obstruction and clear if necessary. See maintenance section for guidance.
3. Plug in the appliance and switch it on. The cut out will reset and the appliance should function normally.
4. If the appliance continues to not function correctly, contact the retailer or place of purchase.

## 6. APP CONNECTION INSTRUCTIONS

### 1. App download

- Download "**Tuya Smart**" from the app store.
- Scan the **QR** code.
- Turn on the "**GPS**" from your mobile device.



### 3. Add device

After account is created, log into account and select the "Add Device" button.

**NOTE:** make sure your mobile phone is well connected to the nearest WIFI signal.

### 2. Login

- Register with your email ID or Mobile phone number as the user name.
- Setup your account password.

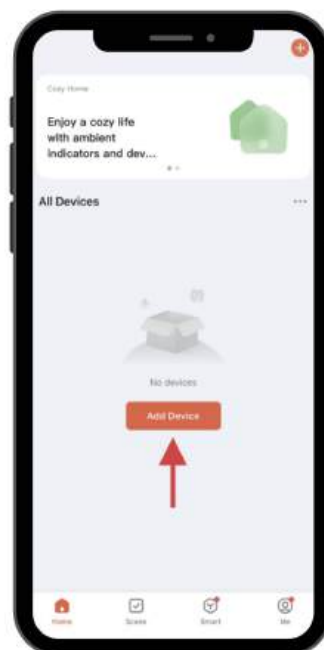

### 3. Add device - Continued

There are three methods to add your Electric Fireplace.

- Method 1: Add Manually on "P0" mode. Please follow below steps A,B,C,D.
- Method 2: Add Manually on "P1" mode. Please follow below steps A,B,C,D.
- Method 3: Add by Bluetooth. Open Bluetooth on your mobile phone before adding.





#### 4. Connecting method 1 - (P0)

- Press & hold  from remote control or control panel until display on control panel shows “P0”.
- Enter the WIFI name and password, then press “Next” button for pairing.
- Press the **Blink Quickly** button for “P0”, device being added.  
When complete, display on control panel shows “P4”, LED Ember-light shows **GREEN** color and flashes 6 times.

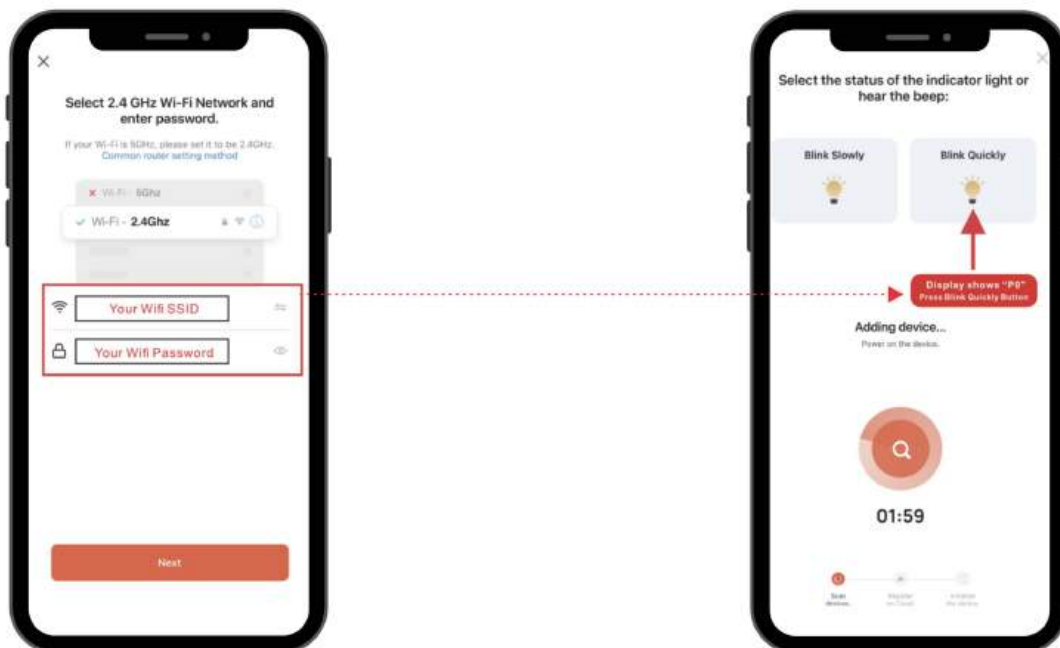

#### 4. Connecting method 2 - (P1)

- Press & hold  from remote control or control panel until display on control panel shows “P1”.
- Enter the WIFI name and password, then press “Next” button for pairing.
- Press the **Blink Slowly** button for “P1”, Then go to connect your mobile phone to the device's hotspot.
- Select device's hotspot (**SmartLife-xxxx**), then back to device. Device being added.
- When complete, display on control panel shows “P4”, LED Ember-light shows **GREEN** color and flashes 6 times.

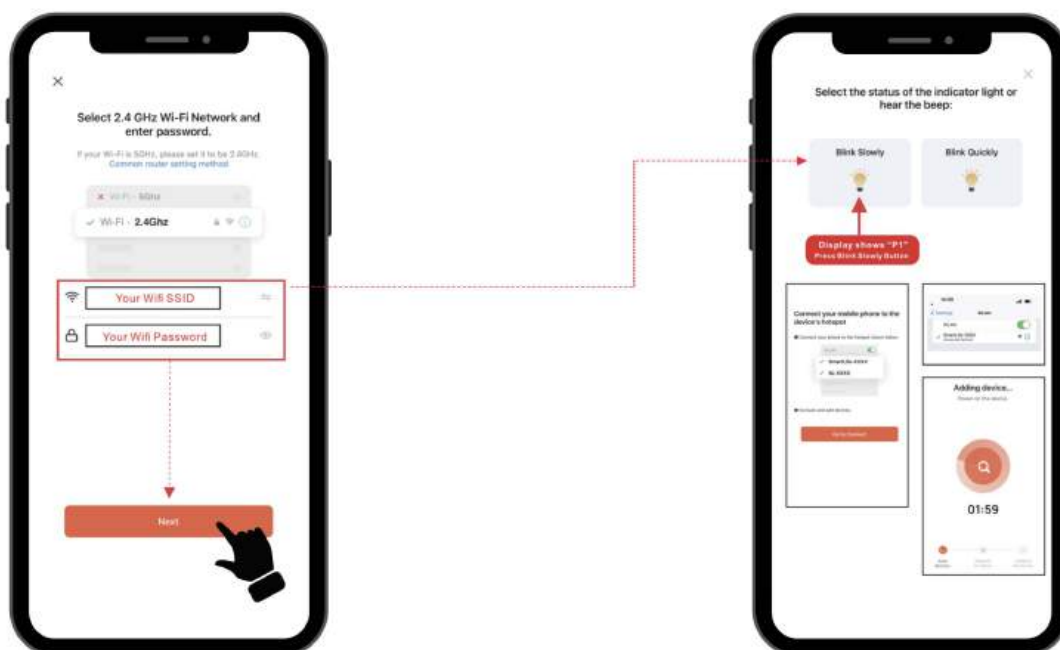

#### 4. Connecting method 3 - (Bluetooth)

- Press & hold  from remote control or control panel until display on control panel shows “P0”.
- Press the **Add** button when you see the device named “ilektro Elite”.
- Enter the WIFI name and password, then press “Next” button for pairing.
- When complete, display on control panel shows “P4”, LED Ember-light shows **GREEN** color and flashes 6 times.



## 5. Complete

- Press **Done** to complete.

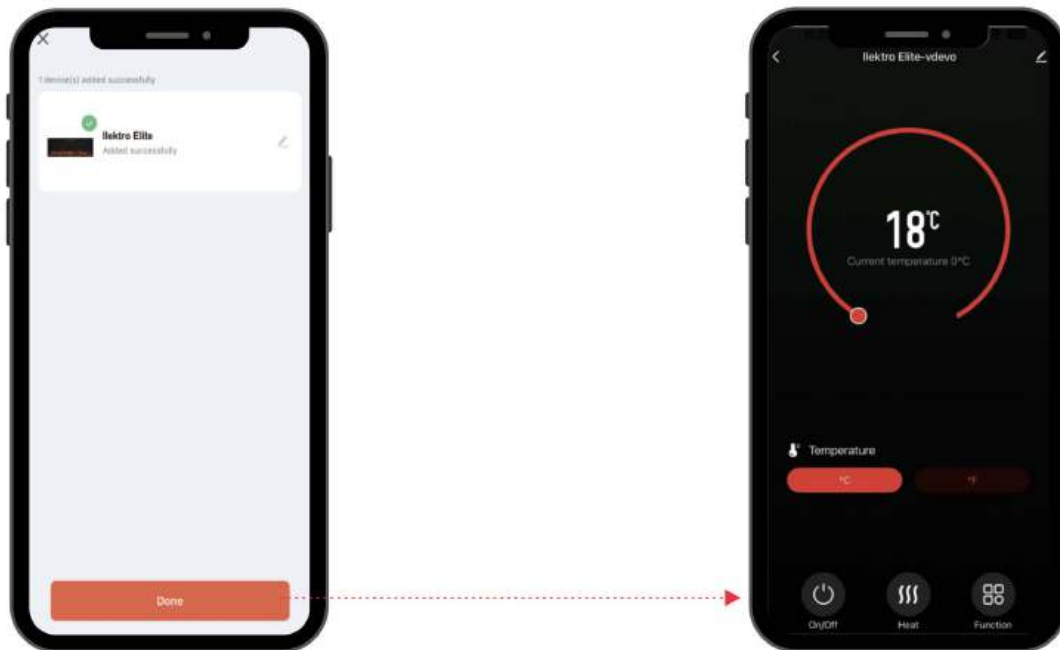

## APP Operating Instruction

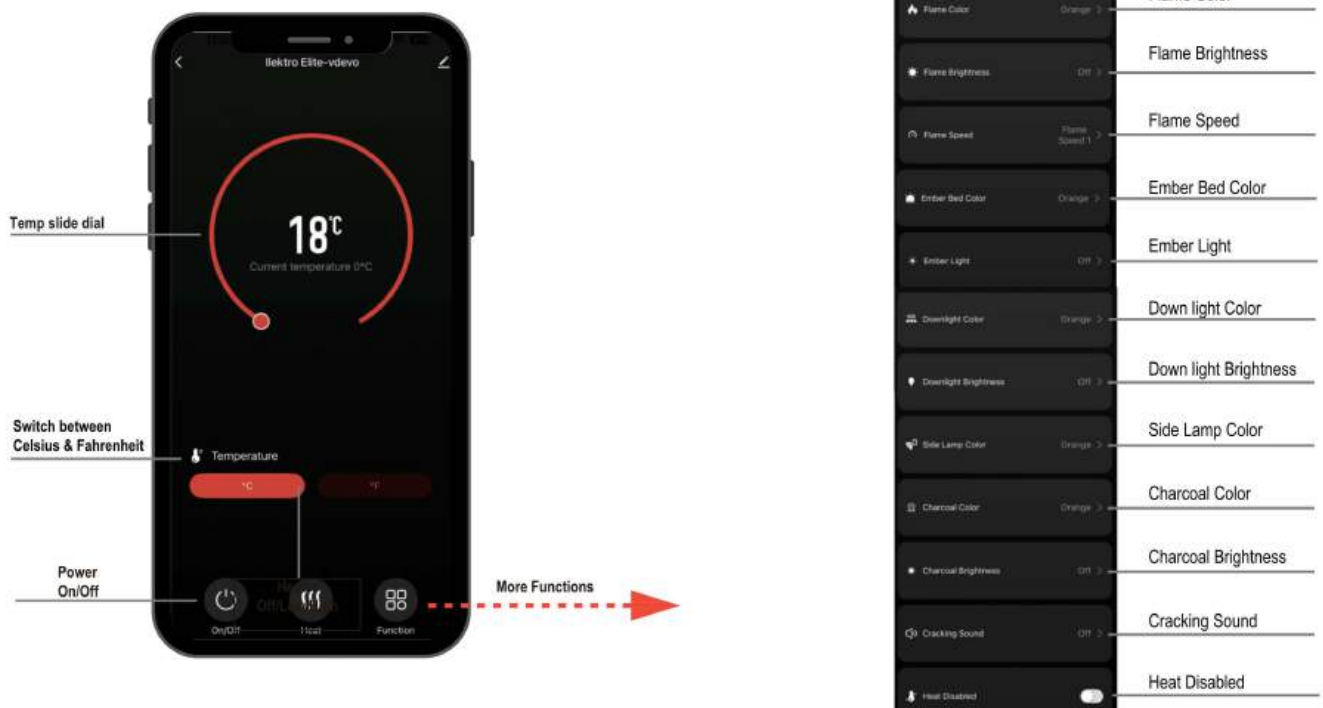



## 7. CARE AND MAINTENANCE

### CLEANING



**ALWAYS** turn the heater **OFF** and **unplug the power cord from the outlet** before cleaning, performing maintenance, or moving this fireplace. Failure to do so could result in **electric shock, fire, or personal injury**.



**NEVER** immerse in water or spray with water. Doing so could result in **electric shock, fire, or personal injury**.

#### Metal:

- Buff using a soft cloth, slightly dampened with a citrus oil-based product.

#### Glass:

- Use a good quality glass cleaner sprayed onto the cloth or towel. Dry thoroughly with a paper towel or lint-free cloth.
- **NEVER** use abrasive cleansers, liquid sprays, or any cleaner that could scratch the surface.

#### Vents:

- Use a vacuum or duster to remove dust and dirt from the heater and vent areas.

#### Plastic:

- Wipe gently with a slightly damp cloth and a mild solution of dish soap and warm water.

### MAINTENANCE



**Risk of electric shock! DO NOT OPEN any panels ! No user-serviceable parts inside!**



**ALWAYS** turn the heater **OFF** and **unplug the power cord from the outlet** before cleaning, performing maintenance, or moving this fireplace. Failure to do so could result in **electric shock, fire, or personal injury**.

#### Electrical and Moving Parts:

- The fan motors are lubricated at the factory and will not require lubrication.
- Electrical components are integrated in the fireplace and are not serviceable by the consumer.

#### Storage:

- Store heater in a clean dry place when not in use.



**WARNING! NO SERVICING** of the internal or electrical parts should be performed by the consumer. Do not service the unit yourself.

## CLEANING THE OUTLETS:

- ENSURE THE APPLIANCE IS SWITCHED OFF AT THE ISOLATION SWITCH
- CLEAN THE AIR OUTLET GRILLES REGULARLY WITH A SOFT CLOTH OR THE NOZZLE OF A VACUUM CLEANER

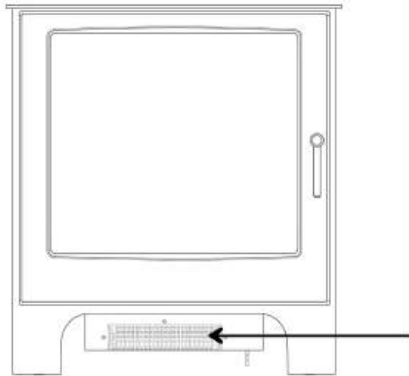

Fig. 11. Electric Stove Grilles

- DUST BUILD-UP CAN INHIBIT EFFICIENT PERFORMANCE OF THE FAN AND LEAD TO THE SAFETY CUT-OUT OPERATING.
- KEEP THE AREA AROUND THE APPLIANCE CLEAN AND FREE OF FLUFF, DUST OR PET HAIR.
- IN PARTICULAR, BUILD-UP OF DUST ETC. CAN OCCUR AROUND THE HEATER VENT AREA. TAKE PARTICULAR CARE TO KEEP THIS AREA FREE FROM SUCH PARTICLES ON A REGULAR BASIS TO PREVENT BUILD-UP.

## CLEANING THE FUEL BED:

TO ACCESS THE FUEL BED IT WILL BE NECESSARY TO OPEN THE GLASS FRONT DOOR.

- ENSURE THE APPLIANCE IS SWITCHED OFF AT ISOLATION SWITCH.
- REMOVE THE LOGS AND DUST CLEAN. DO NOT WET THE LOGS.
- USE A LINT FREE DUSTER.
- LIFT ALL FUEL MEDIUM OUT OF THE FIRE AND WIPE FUEL BED DOWN.
- ENSURE NO MOISTURE REMAINS BEFORE RETURNING THE LOGS INTO POSITION. SEE FUEL BED SET UP.

## BATTERY INFORMATION REMOTE CONTROL:

- THIS REMOTE CONTROL USES CR2025 BATTERY INCLUDED
- INSTRUCTIONS FOR BATTERY INSTALLATION ARE ON THE REMOTE CONTROL BATTERY COMPARTMENT

## BATTERY REPLACEMENT:

WHEN THE REMOTE BATTERIES IS LOW IT MUST BE CHANGED IMMEDIATELY. INSTALL CORRECT REPLACEMENTS AND DISPOSE OF THE OLD BATTERIES CAREFULLY.



NEVER DISPOSE OF BATTERIES IN FIRE. FAILURE TO OBSERVE THIS PRECAUTION MAY RESULT IN AN EXPLOSION. DISPOSE OF BATTERIES AT YOUR LOCAL HAZARDOUS MATERIAL PROCESSING CENTRE.

## BATTERY REPLACEMENT REMOTE CONTROL:

1. SLIDE OPEN THE BATTERY COVER ON THE BACK OF THE REMOTE CONTROL. ENSURE FRONT FACE OF REMOTE IS FACING DOWN.
2. INSTALL BATTERY COIN CR2025 INTO THE REMOTE CONTROL
3. REPLACE THE BATTERY COVER



Fig. 12. Remote Control  
Battery Placement

## DISCARD LEAKY BATTERIES:

DISPOSE OF BATTERIES IN THE PROPER MANNER ACCORDING TO LOCAL REGULATIONS.

ANY BATTERY MAY LEAK ELECTROLYTE IF MIXED WITH A DIFFERENT BATTERY TYPE, IF INSERTED INCORRECTLY, IF ALL THE BATTERIES ARE NOT REPLACED AT THE SAME TIME, IF DISPOSED OF IN A FIRE, OR IF AN ATTEMPT IS MADE TO CHARGE A BATTERY NOT INTENDED TO BE RECHARGED.



## 8. TROUBLESHOOTING

### WARNING

DISCONNECTED THE APPLIANCE COMPLETELY AND LET COOL PRIOR TO ANY SERVICE.  
ONLY A QUALIFIED SERVICE PERSON SHOULD SERVICE AND REPAIR THIS ELECTRIC APPLIANCE.

Problem	Possible Cause	Solution
Fireplace turns off and will not turn on.	1. Fireplace has overheated and safety device has caused thermal switch to disconnect or home circuit breaker has opened.	1. Reset switch by turning main power switch off and waiting 10 minutes then turning it back on or reset circuit breaker.
Flame is not moving.	1. Loose wiring. 2. Flame motor defective. 3. Flame rod out of place.	1. Inspect wiring for loose connections. Call a qualified service technician to replace flame motor. 2. "Flame Rod" out of place due to rough transit / handling of the product. This issue can be corrected as simple as removing the glass, flipping the fireplace upside down, removing a set of screws that are holding the bottom frame plate and placing the flame rod back into place.
Flame is not visible.	1. Wiring is loose.	1. Disconnect from power source and inspect wiring for loose connections and repair or replace if necessary. 2. Push the flame button to high.
Log set and/or ember is not glowing.	1. Wiring is loose. Ember is 2. in off mode.	1. Disconnect from power source and inspect wiring for loose connections and repair or replace if necessary. 2. Ensure the ember button is pressed until on high.
Remote control does not work.	1. Low batteries. 2. Not aiming control correctly. 3. Defective remote control and /or sensor.	1. Replace batteries in remote control. Aim control at sensor located directly behind glass screen in center of unit just above logs. Replace remote control and/or sensor.

Problem	Possible Cause	Solution
Fireplace will not come on when switch is flipped to ON.	<ol style="list-style-type: none"> <li>1. Fireplace is not plugged in to an electrical outlet.</li> <li>2. Control failure.</li> <li>3. Breaker tripped.</li> </ol>	<ol style="list-style-type: none"> <li>1. Check plug.</li> <li>2. Call a qualified service technician. Reset breaker.</li> </ol>
Heater does not provide heat when turned on.	<ol style="list-style-type: none"> <li>1. Thermal switch has been tripped. Wiring</li> <li>2. is loose.</li> <li>3. Heater is defective.</li> </ol>	<ol style="list-style-type: none"> <li>1. Turn unit off and unplug unit for 10 minutes. Plug back in and turn unit on. If plug cannot be reached, follow directions for tripped circuit breaker.</li> <li>2. Disconnect from power source and inspect wiring for loose connections and repair or replace if necessary.</li> <li>3. Replace heater.</li> </ol>
Touch panel / Remote Control do not work.	<ol style="list-style-type: none"> <li>1. The front glass is moved or not secured properly.</li> </ol>	<ol style="list-style-type: none"> <li>1. Unplug the appliance, if the appliance is recessed to the wall, shut off house circuit breaker. Ensure the front glass is in the correct location and is sitting flat to the appliance touch panel. After 15 seconds, plug or turn on the appliance to reset it.</li> </ol>

## SERVING INSTRUCTIONS - OPERATE APPLIANCE BEFORE COMMISSIONING:

1. Click on the remote handset power button. If the appliance does not function, then follow the following steps.
2. Check the power connection and that the isolation switch is on.
3. Check the isolation switch on the appliance. The switch must be set to the 'I' position.
4. Check the batteries in your handset. Check if the batteries are in the correct position and refit if necessary.
5. If after completing the above steps, problem still remains, disconnect the power from the mains (unplug from socket), and wait for 60 seconds. Plug it back in and repeat above steps.

## 9. GENERAL INFORMATION

### SERVICING INSTRUCTIONS:

THIS APPLIANCE MUST ONLY BE SERVICED BY A SUITABLY QUALIFIED PERSON.

BEFORE UNDERTAKING ANY WORK ON THE APPLIANCE: SWITCH OFF THE APPLIANCE FROM THE ISOLATION SWITCH.

WAIT FOR AT LEAST 10 MINUTES UNTIL THE APPLIANCE HAS COOLED DOWN.

REMOTE HANDSET BATTERY REPLACEMENT  
THE REMOTE-CONTROL HANDSET, USES 1 BATTERY COIN CR2025 FOR POWER OPERATION, THESE WILL NEED REPLACING OVER A PERIOD OF TIME.

FOR REPLACEMENT:

- OPEN THE BATTERY COMPARTMENT COVER ON THE REAR OF THE HANDSET.
- REMOVE THE OLD BATTERIES AND REPLACE OBSERVING THE CORRECT POLARITY (+ & -) AS MARKED UPON THE BATTERIES AND
- HANDSET REMOTE CONTROL. REPLACE THE HANDSET COVER.

### RESETTING THE THERMAL CUT OUT SWITCH

THE APPLIANCE IS FITTED WITH AN ELECTRONIC SAFETY CONTROL (E.S.). THIS IS A SAFETY DEVICE WHICH SWITCHES OFF THE HEAT ONLY IF, THE APPLIANCE OVERHEATS FOR ANY REASON  
E.G. WHEN COVERED.

IF THE HEATER STOPS OPERATING WHILST THE FLAME VIDEO CONTINUES NORMALLY, THIS INDICATES THAT THE E.S. CONTROL IS IN OPERATION.

THE E.S. CONTROL CAN ONLY BE RE-SET AFTER THE APPLIANCE HAS COOLED DOWN.

TO RE-SET THE E.S:

- SWITCH OFF THE APPLIANCE (ISOLATION SWITCH) AND LEAVE FOR UP TO 2 HOURS.
- REMOVE ANY OBSTRUCTION TO THE FAN HEATER OUTLET OR OTHER INTERNAL PARTS.
- SWITCH ON APPLIANCE AND THE E.S. CONTROL WILL RE-SET.
- ENSURE THAT THE APPLIANCE IS FUNCTIONING CORRECTLY. IF THE E.S. CONTROL OPERATES AGAIN, THE APPLIANCE SHOULD BE CHECKED BY A COMPETENT ELECTRICIAN.

IF THE POWER SUPPLY IS INTERRUPTED (POWER FAILURE) OR THE APPLIANCE IS TURNED OFF AT THE ISOLATION SWITCH WHILST THE HEATER IS ON, IT WILL BE NECESSARY TO DISCONNECT THE APPLIANCE FROM THE MAINS SUPPLY AND LEAVE FOR 5 MINUTES IN ORDER TO DISCHARGE THE ELECTRONICS BEFORE ATTEMPTING TO TURN THE APPLIANCE ON.

## 10. WIRING DIAGRAM

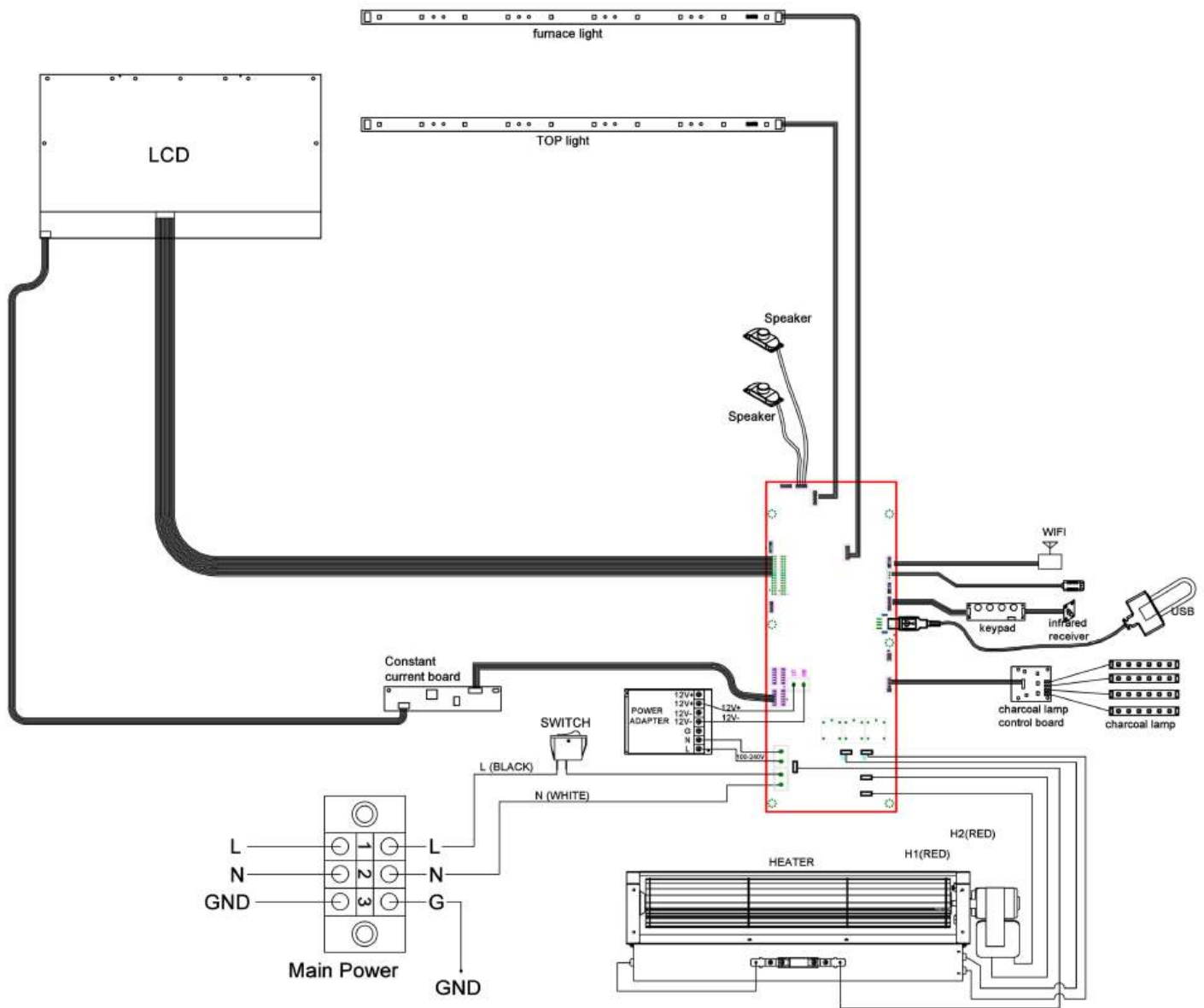

220V/240V 2000W

Fig. 13. Electric Stove Wiring Diagram



# iléktró

148 Cochranes Road  
Moorabbin, Victoria 3189

[www.paulagnewdesigns.com.au](http://www.paulagnewdesigns.com.au)

[info@paulagnewdesigns.com.au](mailto:info@paulagnewdesigns.com.au)