

USE AND MAINTENANCE INSTRUCTION MANUAL

INSET: DINDER 60 | DINDER 70 | DINDER 80
FREESTANDING: DINDER 60 | DINDER 70 | DINDER 80



Please observe all national regulations, particularly those referring to national and European standards, when installing the device.

The installer must be aware of and implement any more restrictive national or local rules or regulations.

1. NOTE FROM THE MANUFACTURER

Thank you for choosing one of our models. Please read this manual carefully. His intention is to give you advice on installation, use and maintenance. If you need any further clarification, please contact your dealer or the manufacturer directly.

Our models are designed to improve the performance of any conventional fireplace. Air enters through the bottom of the front and comes out hot at the top. Optionally, the hot air can also be blown to the top of the chimney hood and to other surrounding rooms.

The fireplace's interior is made of high-quality steel covered with pieces of refractory material or vermiculite plates.

Note: Graphic representations and drawings included in this manual may not correspond exactly with your model.

2. WARNINGS

When installing the device, all local regulations must be observed, including those referring to national and European standards.

Expansion and retraction phenomena can occur during warming and cooling episodes; These should not be considered defects.

Certain parts of the appliance, especially the external surfaces, are hot during operation and remain hot after the fire is extinguished. You should pay attention to this and handle the device with the glove provided for this purpose.

Storage or even brief exposure of flammable or fire or heat sensitive products near the device is strictly prohibited.

Never use gasoline, lamp oil, kerosene, barbecue lighters, alcohol or similar liquids to ignite or "reignite" combustion in the appliance. Keep all these liquids away from the device during use.

Radiation, especially through glass surfaces, can ignite combustible objects located around the device and a minimum distance should be maintained between these objects and the device.

It is mandatory to respect safety distances from combustible materials as described in the "TECHNICAL INFORMATION" section and not place or store anything in the direct radiation area of the device. Extreme fire hazard.

Making unauthorized modifications to the device is a source of danger and will immediately void the warranty.

This appliance is designed to operate only with the doors closed.

The combustion chamber and ashtray compartment must remain closed to avoid problems such as smoke backflow except for ignition, charging or recharging or waste disposal.

Do not open too quickly and do not lean on the fireplace door to get up. This could damage the door attachment.

The symbol  present on the device's nameplate means reading and following the installation and use instructions.

INSTALLATION

RECEPTION OF THE DEVICE

Check that your device has not been damaged during transport. Check the window, the door opening, the operation of the controls and the condition of the interior lining of the chimney (bricks, vermiculite).

DEVICE LOCATION

Your device is not designed to operate in a negative pressure room.

The presence of an extractor hood, or other heating device that requires air in a very airtight house, can cause disturbances (poor combustion, smoke reflux, etc.). Check that sufficient air can be extracted from the premises for the combustion of firewood. When the air intake into the room is insufficient, it is necessary to create an additional air supply specific to the device.

Your device is not designed to be installed in a halogenated environment (presence of chlorine, fluorine generated by swimming pools or SPA) or a high humidity environment that could cause oxidation of the constituent parts of the device. This oxidation can be amplified in case of occasional use or if installed in a coastal region (salt air).

Before any work, it will be necessary to carry out an accurate and professional examination of the future site and the connecting duct. Furthermore, it is essential to consider the dimensions of the device, as well as the minimum opening dimensions of the casings present in the *“TECHNICAL DETAILS”* chapter.

The device must be installed on a floor with sufficient load capacity. If an existing construction does not meet this prerequisite, appropriate measures must be taken (e.g. installation of a load distribution plate) so that the ground can support the device.

All preparatory work for the installation of your device must be carried out before installation (flue duct, outside air intake, masonry, etc.).

We recommend installing the device in a room free of water and air. Dust from work can settle on the appliance and burn when it is put into service, causing ceilings to darken and emit unpleasant odours. Therefore, it is recommended to wait until the work is completed to install your device.

Check the nature of the materials that make up the back walls, floor and ceiling.

The floor must be made of non-combustible material.

Combustion air

The adequate air supply for the operation of the device must have a minimum useful surface area at least equivalent to the values indicated in the “*TECHNICAL DETAILS*” chapter. It should be located directly outside or in a room with external ventilation and open to the base of the chimney. It must be permanent and protected by a grill.

During operation, this air inlet grill must be clear and unobstructed. A failure in the combustion air supply will cause major malfunction of the device.

This appliance must not be connected to an air supply serving another appliance.

It is preferable to make a connection to outside air to optimize combustion regulation. Depending on the specific conditions of the building (tightness, presence of an extractor hood, etc.), it is mandatory to create a specific air inlet for the device.

It is important to note that any subsequent modification of the conditions of use (a hood or any other air extraction device, insulation work or improvement of tightness, etc.) may cause malfunctions (reflow of smoke, for example).

Chimney

All our models are designed and manufactured for optimal performance. However, the operation and performance you get will depend largely on the installation.

- The fireplace must comply with the standards, have the CE marking and be built in compliance with safety regulations.
- The conduit must be suitable for the specific operating conditions of the device to be installed and appropriately sized according to the latter according to the NF EN 16510-1 standard; must ensure the minimum circulation prescribed in the “Technical information” chapter.
- The duct components must have a fire resistance class G and a minimum temperature class higher than the declared temperature on the device nozzle.
- It is obligatory to have a class D at nominal power.
- A flue can only serve one device.
- The chimney must be at least resistant to chimney fire and class **T400G**.
- The device must be connected to a smoke duct that guarantees sufficient draft from the chimney (minimum 12 Pa).
- The duct must have sufficient height, no less than 4m. and must exceed at least one meter the maximum height of the building and other surrounding buildings, including trees and other obstacles within a minimum radius of 10m.

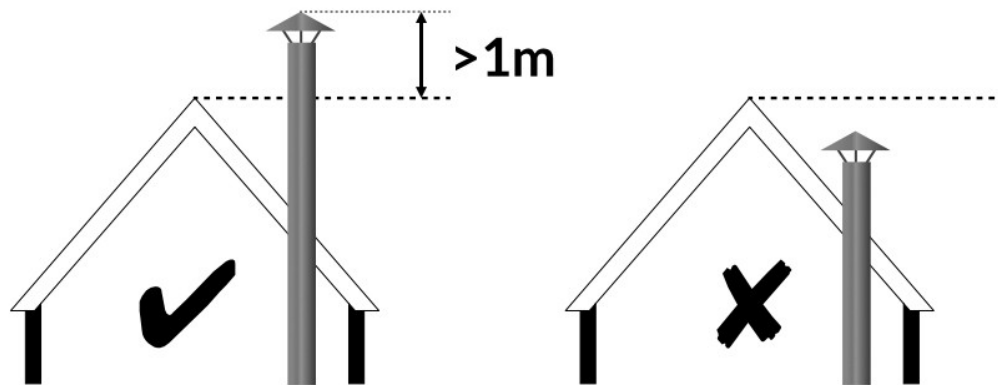

- The diameter of the smoke outlet of the appliance is ideal to maintain a good draft, avoid making reductions as much as possible.
- It is advisable that the chimney be inside the building. Install double-walled insulated pipes when the chimney duct runs outside the building.
- When you need to make angles or elbows in the duct, avoid horizontal or downward sections. You must plan to clean the duct; if necessary, install tubes with registers or cleaning cloths in difficult-to-access sections.
- When a metal chimney is inserted inside a brick chimney, it must exceed the height of the chimney and protrude a few centimeters from the top.
- The installation of the tube and cap must strictly prevent water from entering the interior of the device on rainy days. Water causes greater deterioration in stoves than the high combustion temperatures for which they are prepared.
- When the tubes are inside the home or a brick chimney, it is advisable to mount them in the direction indicated in *Figure 1*, to prevent the liquids produced by the condensation of the gases from flowing through the joints out of the tubes. If any section of pipes is outside the building, it must be mounted in the direction indicated in *Figure 2*, to prevent rainwater that runs off the outside of the pipe from entering the inside of the pipe through the joints.

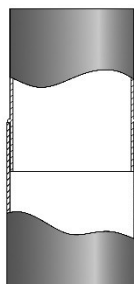

Figure 1: correct installation running on house interior. Liquids produced by gas condensation do not flow to the exterior through the pipe joints

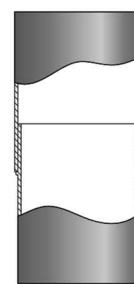
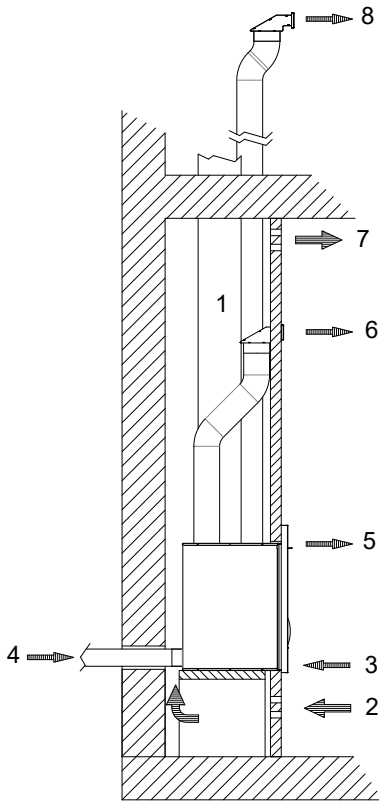

Figure 2: correct installation for parts running on house exterior. Rainwater does not reach the inside of the pipe through the pipe joints

ADDITIONAL INSTALLATION TIPS

The installation of the appliance must comply with all local regulations, including those referring to national and European standards.

CARBEL will be responsible for the provided appliance, but in no case for the installation of the same.



1. Fumes exhaust pipe \varnothing 200 or 150, according to model.
2. Entry of air into the chimney chamber by natural convection.
3. Entry of air into the cassette convection chamber, drawn in by fans.
4. Optional entry of air from the outside used for combustion (optional lower or rear connection)
5. Hot air outlet at the top of the front blown by fans.
6. Hot air outlet driven by fans.
7. Hot air outlet of the chimney chamber by natural convection.
8. Optional outlet for hot air to other rooms, blown by fans

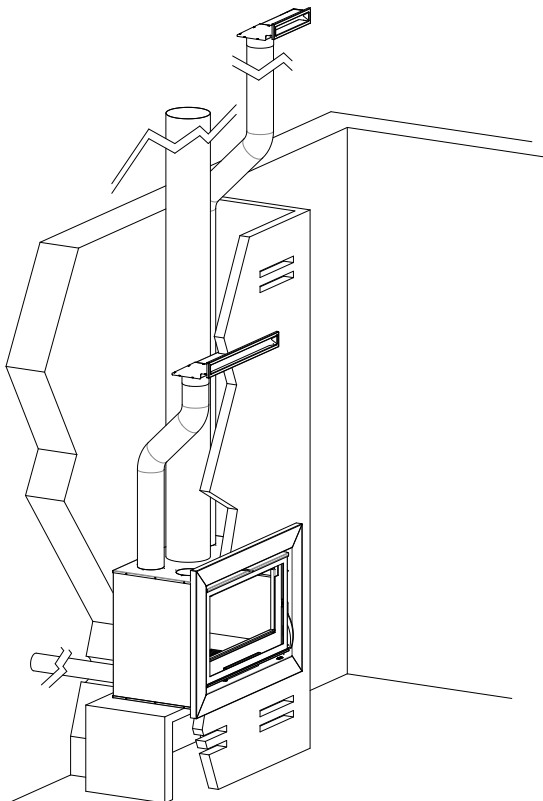

Warning.

Any installation should be done by an authorised installer. A faulty installation of this product, and an inadequate maintenance might cause grave incidents.

For inserts, we recommend installing the appliance with a cover made of an insulating material, such as rock wool. (EN 14303:2009 EUROCLASSE A1 $\lambda_D(50^\circ\text{C}) = 0.039\text{W}/(\text{m}\cdot\text{K})$)

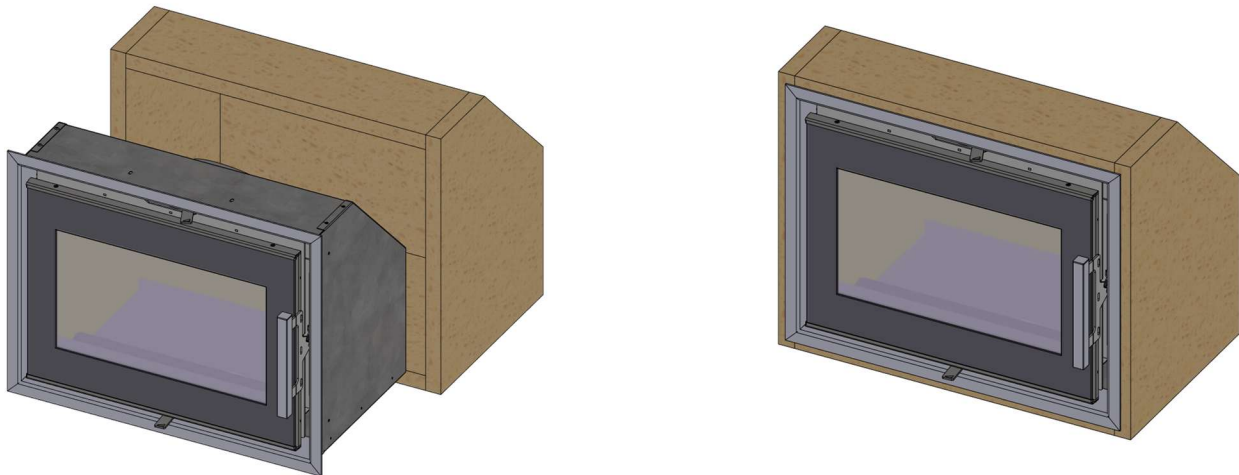

The finish on site must be such that it allows the stove to expand during operation; the work should never be rested on top of it, nor against the sides of the device. Leave a minimum expansion joint of 0.5cm. on each side and 1cm. at least in the upper part of the front.

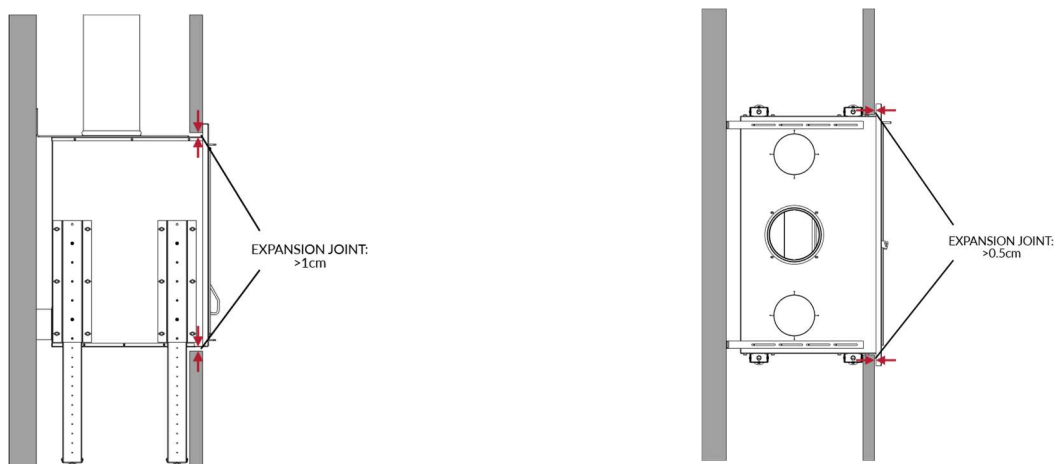

HEAT RECOVERY

It is possible to add air ducts classified M0 or A1 or A2 to distribute the air in the room where the device is located to the convection air outlets.

If hot air is distributed by drawing from the convection chamber, consult the system manufacturer's recommendations.

OPERATION

GENERAL PRESENTATION

Primary and secondary air inlet controls

You have purchased an insert model that offers maximum efficiency and performance. Therefore, control of the primary and secondary air inlet is essential to achieve optimum combustion levels.

The optimal regulation of the air inlets can vary depending on various factors, such as the chimney flue, the temperature of the wood burner, the quality of the wood (moisture, size and shape).

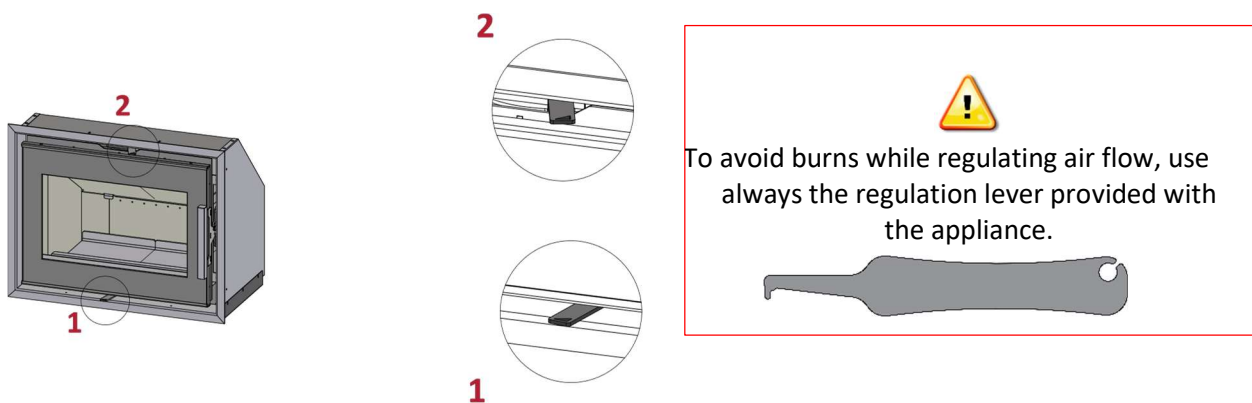

- (1) Secondary air inlet regulation.
- (2) Primary air inlet regulation.

It is necessary to use the glove supplied with the device to manipulate the different regulation devices.

Adjusting air when lighting a fire

- Primary air inlet

It is essential to open this inlet to maximum position when lighting the fire and to leave the door half-closed to avoid the condensation of fumes on the glass.

You must wait enough time (until the appliance has warmed up) before adjusting the air inlet.

- Secondary air inlet

Open fully when lighting a fire

Adjusting air during operation

- Primary air inlet

During normal operation of the burner, once the appliance has warmed up, you must close the primary air inlet to achieve good combustion performance.

If the quality of the firewood allows it, the primary air inlet must be fully closed or slightly open (no more than 1 cm).

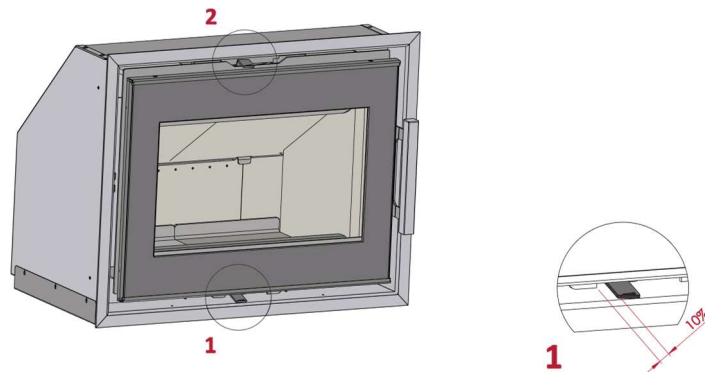

PRIMARY AIR REGULATION LEVER POSITION FOR NOMINAL POWER, LEAVE OPEN 10% OF ITS RANGE (5 mm.).

- Secondary air inlet

Secondary air adjustment is the one that will provide better combustion that is cleaner and more efficient, making the most of every load of firewood.

You can adjust the entry of secondary air when the apparatus is hot enough and burning with a good flame. During normal operation, you must never close the secondary air inlet completely. Normally, the secondary air must be adjusted to a minimum opening of 15-20%.

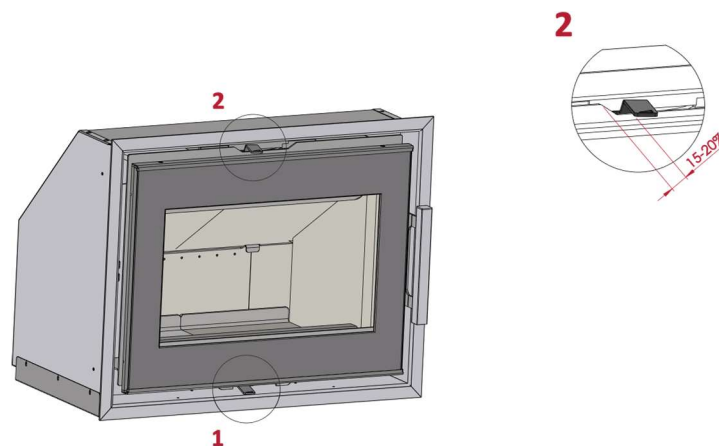

SECONDARY AIR REGULATION LEVER POSITION FOR NOMINAL POWER, OPEN 25% OF ITS RANGE.

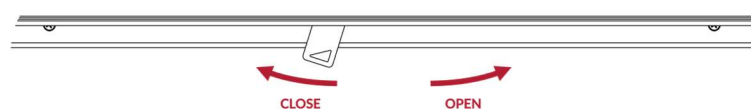

Tips for using your cassette and OPTIMAL adjustment of the air intakes:

Once the unit has completed a first combustion cycle and it is hot enough, it is advisable to follow these Recommendations to get the most out of your product.

Spread the embers from previous combustion cycles across the bottom of the burner.

It is preferable to use opened beech or similar wood with a humidity percentage of less than 20%.

Recommended fuel size:

Mod. DINDER 60: 1 piece of wood between 25 and 30 centimeters in length and 1 to 1.6 kg weight.

Mod DINDER 70: 1 piece of wood between 30 and 35 centimeters in length and 1.25 to 1.8 kg weight.

Mod. DINDER 80: 1 piece of wood between 35 and 40 centimeters in length and 2.3 to 2.6 kg weight.

- Adjust the primary air inlet to an opening of between 5 and 8 mm.
- Adjust the secondary air inlet to halfway, i.e. at an angle of approximately 90° with the front of the device.

To obtain stable and optimal performance and a clear view of the flames through the glass try to make consecutive loads of wood with pieces as similar as possible, for that you must keep the same air inlet regulation at any time.

Wood fuel

It is recommended to burn only dry, hard wood (hornbeam, ash, beech –G1 H1).

Use logs whose dimensions are suitable for fireplaces and that have been dry for at least two years. Its storage must be done under cover. Firewood that is too wet can cause blockages in the windows, the internal walls of the chimney and the flue, poor performance and significant polluting emissions.

Wood burners and inserts are intermittent combustion appliances. This means that they should be lit, loaded with an approximate weight of fuel as recommended by the manufacturer for each model, followed by a full combustion cycle and fuel reloads after each combustion cycle.

Good combustion is necessary for optimum performance and a better view of the flames through the glass.

Guidelines:

- Maintain a high and constant temperature in the fireplace. Accordingly, the fireplace door must be always closed and opened only to load firewood, which must be done as quickly as possible. Keeping the door open will cause the stove to cool down, it will worsen the combustion and make lighting of the new wood more difficult.
- Once the unit has completed a first combustion cycle and the flames are out, open the door spread the embers and load the wood logs.

It is prohibited to use your device as an incinerator.

The use of liquid fuels or fuels not recommended and not suitable for the appliance is not permitted.

We decline all responsibility for the deterioration of parts caused using fuels other than those recommended.

Wood burner performance also depends greatly on the fuel used. The wood must be dry to get more heat (less than 20% humidity). It will also be easier to regulate heat and keep the wood burner and flue in better condition. Store firewood in a dry, ventilated place protected from the rain for at one to two years depending on the storage and weather conditions.

Use opened pieces of wood, it will burn better than logs. The best would be opened pieces with a similar section and shape.



- You can also use compressed-wood logs, such as briquettes.
- Avoid softwoods, such as pine, because they produce a lot of smoke and soot that dirty the glass.
- Do not use flammable liquids to light the fire; always keep them away from the wood burner.
- Do not use the wood burner as an incinerator, never burn plastics, waste, garbage or rubbish.
- Remove the ashes when the wood burner is off and place them in a metal container as there may be burning embers hidden in the ashes.

Advantages of using good quality wood:

- Better heating power
- Better control of the fire regulation
- Helps to keep a clean glass
- Helps to keep the wood burner and flue cleaner and in better conditions
- Hotter and more shining fire



Disadvantages of using wet and inconvenient wood:

- Lower heating power
- Dirtier glass.
- Water evaporation might oxidize metallic parts in the stove
- Dirtier combustion chamber and flue
- Duller fire
- More accumulation of smoke



Overloading the appliance with firewood decreases performance, reduces energy efficiency and accelerates the wear and tear of the appliance.

Do not exceed the maximum load of firewood given at the end of the manual.

Lighting a fire

Important: The lighting of the fire must be done with thin dry wood.

The ignition process is the most important operation, a fast and vigorous ignition must be carried out to achieve a high temperature in the stove, without it you will not be able to achieve optimal operation.

1. Load a generous load of small or medium size open firewood, with a generous layer of wood chips or thin firewood on top. You should leave the pieces crossed and with enough separation between them to allow proper air flow.
2. Light the top layer of wood chips or thin wood, preferably the area closest to the door, and using special products to set alight, if necessary.
3. Leave the door ajar, with an opening between 0,5cm to 3cm, so that enough air can enter for the fire to light quickly.
4. Once the wood is well-lit, wait until the wood burner temperature is high before completely closing the door (10 to 45 minutes, depending on factors like wood, air circulation, etc.) and adjust the air inlet. If you find that the volume of flames decreases, or the fire tends to go out and the smoke inside the fireplace increases, open the air intake more or repeat step 3.

When you reload with more wood, if there are not enough embers to light the new load of wood, repeat steps 3 and 4.

When the wood burner is in operation, you must not open the door. When putting more wood on the fire, open the door slowly to prevent the smoke inside the fireplace from blowing out into the room.

Your device operates intermittently and the recharging interval at rated heat output is approximately 45 minutes.

With partial load, it is approximately 42 min

Maximum reloading height: 150 mm.

The use of the glove for recharging is mandatory. Risk of serious burns.



During the use of your insert or stove, the high temperatures generated during combustion and subsequent cooling cause expansion and contraction in the steel. This phenomenon, while normal, can produce a metallic sound. In no case can this be considered a defect in the product.

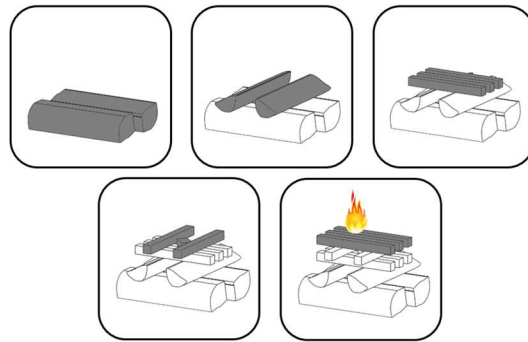

Operation in adverse weather conditions and in the first period of use

In the first period of use or in adverse weather conditions (for example, during fog, on humid and rainy days, in weather conditions with strong gusts of wind or when the outside temperature exceeds +15°C), the draft of the chimney may become too weak to remove all combustion gases. To compensate for this negative effect, the chimney should be loaded with as little fuel or additional dampers as possible.

MAINTENANCE

Warnings:

It is prohibited to touch, rub or clean the device when it is hot: Risk of serious burns. All maintenance should be performed on a cold device.

We recommend cleaning with a soft, damp sponge or soft cloth.

To ensure the correct functioning of the installation, periodic cleaning of the appliance, the connection duct and the chimney is necessary. It is essential to check the absence of obstructions in the duct before restarting it after a long period of stoppage.

It is necessary to control and maintain a good state of cleanliness of the convection grilles (for inserts).

After a prolonged period without using the stove, you should check that there is no blockage in the chimney duct.

- Periodic cleaning of the chimney flue, chimney cap, stove and connection to the stove should be carried out. They must be kept clean and in good condition, the accumulation of creosote in the chimney could cause it to catch fire.
- It is essential to keep the smoke duct clean. The number of chimneys sweeps to be carried out will depend on the frequency of use of the product, the type of fuel used, as well as its humidity levels.
- Chimney sweeping and product maintenance must be carried out by a qualified professional.
- The door seals are made of fiberglass, ensuring a long lifespan: they should be replaced as soon as they lose their flexibility. You can request them from your installer.
- The appliance should not be used if the door seals are damaged.
- To clean the glass, you must be careful to spray it on a cloth or cloth and clean only the glass, without wetting the rest of the door. Glass cleaners and special products usually contain chemicals that attack the paint, ceramic fiber joints and cause oxidation of metal parts.

It is very important not to wet the stove with glass cleaner, water, or special cleaning products.

Anti-heat paint is not waterproof.

Clean the paint with a duster or a soft, dry cloth. If you want to restore it over time, the manufacturer has spray paint that you can purchase from your distributor.

Respect the minimum safety distances from adjacent combustible materials.

In the event of a chimney fire, remove occupants from the house.

Call the fire department by dialing "18" or "112".

Disconnect the house's electrical installation into your electrical closet. Reduce air intake into the room by closing windows and blocking air intake vents from the outside, if you have one. Get out of the house.

Don't do anything that could endanger you or your loved ones.

Ash removal:

- It is better to clean the floor of the home with an ash vacuum cleaner or a shovel/broom before removing the ashtray.
- Only empty the ashes when the coals are completely cool (the latter can be hot up to 24 hours after the fire has gone out).
- It is necessary to use a non-flammable container placed on a non-flammable cover.
- We recommend the use of an ash vacuum cleaner.

PROBLEMS/SOLUTIONS

PROBLEM	POSSIBLE SOLUTION
Dirty glass Reflux when opening the door. Condensation Corrosion	<ul style="list-style-type: none"> - Burn firewood with humidity < 20% - Increase combustion air supply * - Check the air intake settings of the device. - Clean the device - Check the frequency of the chimney sweep (twice a year, including once during the period of use) - Clean the smoke outlet of any obstructive element - Lift the smoke outlet plug - Raise the smoke duct (protruding 100 cm from the ridge) - Insulate the chimney
Wood is difficult to burn.	<ul style="list-style-type: none"> - Use smaller section wood or quarters - Place at least two logs - Burn firewood with humidity < 20% - Increase combustion air supply * - Clean the smoke outlet of any obstructive element * - Lift the smoke outlet plug * - Raise the smoke duct (protruding 40 cm from the ridge) * - Insulate the chimney *
Wood burns too quickly.	<ul style="list-style-type: none"> - Place logs of larger section. - Check the presence of deflectors on the device * - Check the air supply settings to the device * - Install a draft regulator*
Excessive soot buildup	<ul style="list-style-type: none"> - Burn firewood with humidity < 20% - Increase the combustion air supply. - Clean the smoke outlet of any obstructive element (e.g. satellite dish, etc.) * - Lift the smoke outlet plug * - Raise the smoke duct (protruding 40 cm from the ridge) * - Insulate the chimney *

* This operation must be carried out by a qualified professional

RISK ASSESSMENT

Risk	Security level	Details to check	Possible solution
Power supply failure	The appliance is designed to work without Power Supply.	Check the electrical circuit	
Malfunction of combustion air supply	- NPD		
Convection air fan failure	The appliance is designed to work without Fans	Check the electrical circuit	
Blockage of the chimney	- NPD	Check and clean chimney at regular intervals	Clean the smoke outlet of any obstructive

SPARE PARTS

Only the use of original parts guarantees the validity of the warranty and the correct functioning of your device. You will find the spare parts at your CARBEL specialized distributor.

INFORMATION ON DISASSEMBLY / RECYCLING / DISPOSAL AT THE END OF ITS USEFUL LIFE

Since the installation of your product is specific, we recommend that you never disassemble the installation yourself. Calling and supporting your installer will allow you to check together the possibilities available to you in terms of disassembly and recycling of your device, ducts, coatings, etc.

Your product cannot under any circumstances be treated as household waste; it must be delivered to a collection center responsible for recycling.

Improper disposal of the device by the owner entails the application of the sanctions provided for by current local regulations.

Selective sorting, which allows the recycling of a device at the end of its useful life and its environmentally friendly treatment, helps to avoid possible negative effects on the environment and health. Promotes the reuse and/or recycling of the materials that make up the device.

For more information about existing waste collection centers, contact the waste collection service in your municipality or the store where you purchased your device.

All waste resulting from installation or disassembly of the device must also be carefully sorted and then thrown into appropriate containers or sorting centers.

CERTIFICATE OF WARRANTY

NAME
TOWN/CITY
PROVINCE

ADDRESS
POSTCODE
TEL:

E-MAIL:

MATERIAL EXCLUDED FROM WARRANTY

*Deflector, paintwork, chromework
Vermiculite, glass, seals
and other moving parts*

ELECTRICAL COMPONENTS

2 YEARS

BODY

3 YEARS Stoves

This warranty covers the faulty part and the shipping to your dealer.

This warranty covers defaults in spares and manufacturing process.

The warranty does not cover damages in the appliance caused by an improper use or negligence.

The appliance must be installed by a professional installer.

All appliances must be installed according to the instructions manual and current regulations in each country.

The manufacturer declines all liability for breach of the instructions manual.

To be covered by the warranty, a copy of this certificate and a copy of the invoice must be sent to the manufacturer.

DEALER'S SIGNATURE AND STAMP

CUSTOMER'S COPY

CERTIFICATE OF WARRANTY

NAME
TOWN/CITY
PROVINCE

ADDRESS
POSTCODE
TEL:

E-MAIL:

MATERIAL EXCLUDED FROM WARRANTY

*Deflector, paintwork, chromework
Vermiculite, glass, seals
and other moving parts*

ELECTRICAL COMPONENTS

2 YEARS

BODY

3 YEARS Stoves

This warranty covers the faulty part and the shipping to your dealer.

This warranty covers defaults in spares and manufacturing process.

The warranty does not cover damages in the appliance caused by an improper use or negligence.

The appliance must be installed by a professional installer.

All appliances must be installed according to the instructions manual and current regulations in each country.

The manufacturer declines all liability for breach of the instructions manual.

To be covered by the warranty, a copy of this certificate and a copy of the invoice must be sent to the manufacturer.

DEALER'S SIGNATURE AND STAMP

CUSTOMER'S COPY

ANNEX I: DISMANTLING OF THE BAFFLES

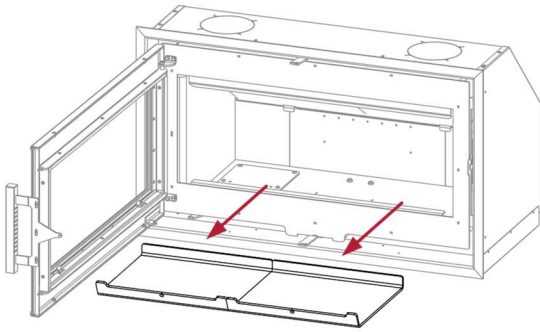

Step 1:
Take out the base of the device.

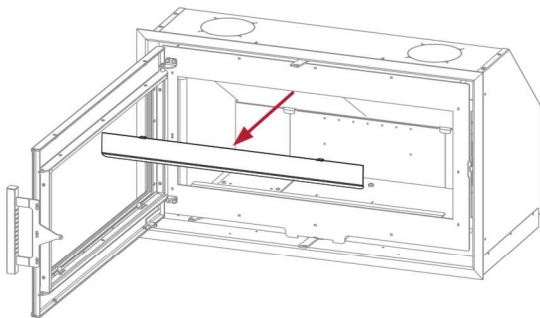

Step 2:
Take out the anti-revoking baffle plate.

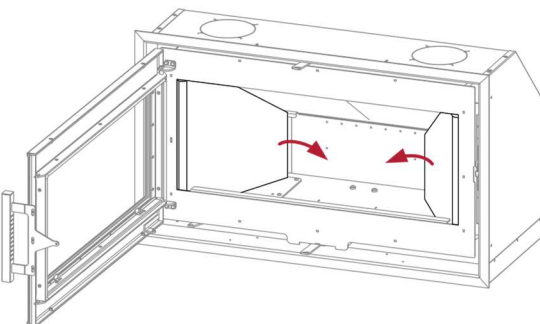

Step 3:
Take out the side panels

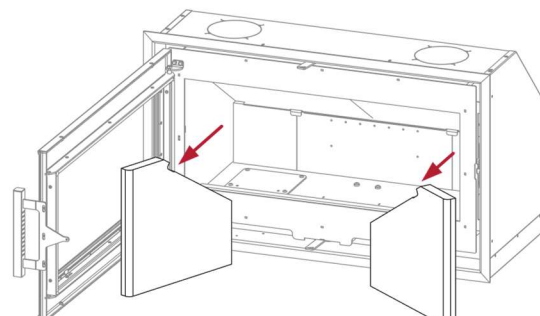

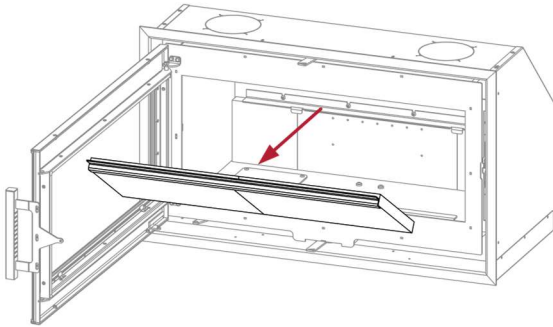

Step 4:
Take out the refractory baffle from the top

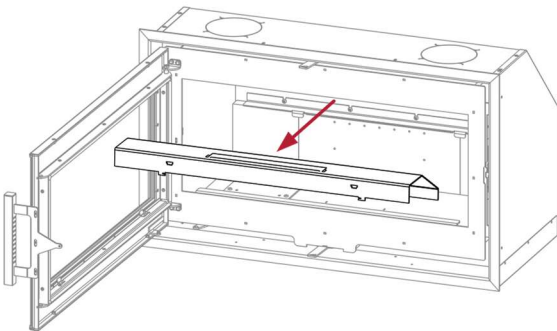

Step 5:
Take out the second baffle

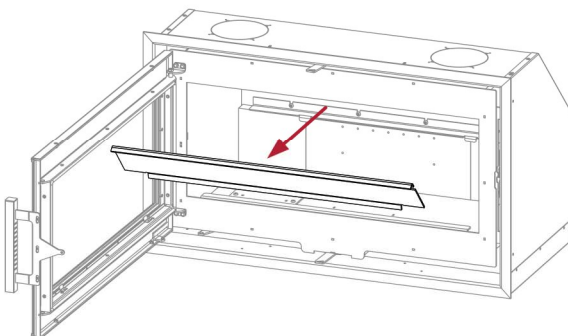

Step 6:
Take out the third baffle

Please note, for re-assembly of the device, follow these steps in the reversed order

ANNEX II: Legs Assembly.

1. Screw the guides to the chamber using the holes already provided.

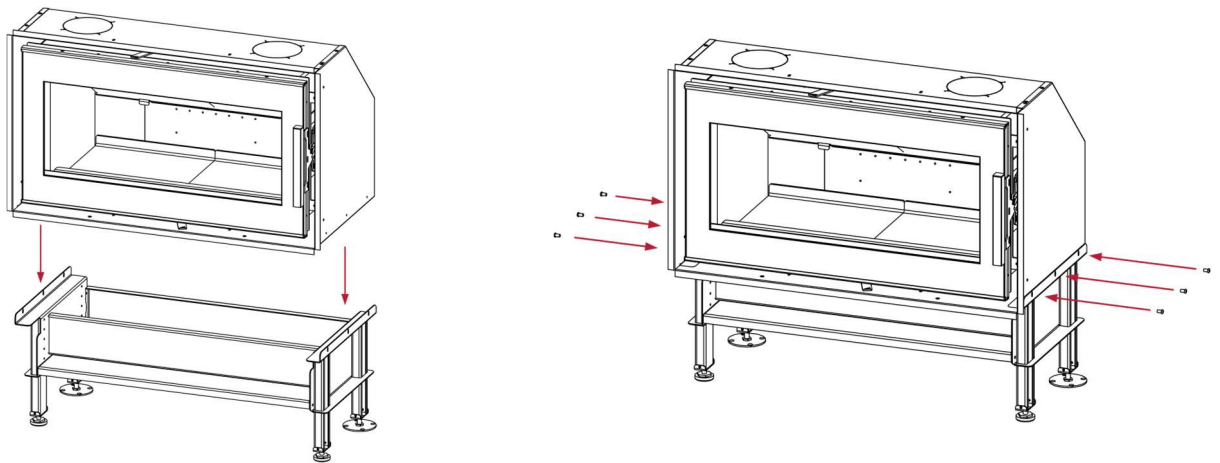

2. Insert the legs into the guides.

3. Fix the legs to the desired height using the screws.

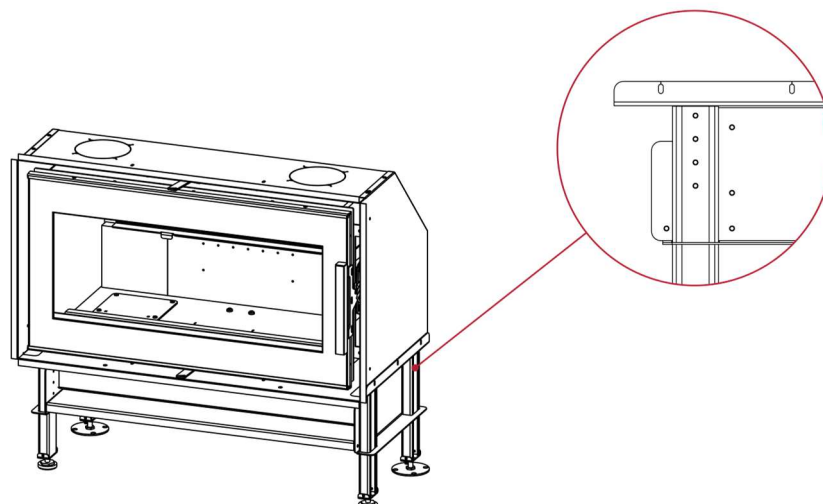

ANNEX III: Combustion Air Inlet Connection Assembly.

Connect and fix the air entry connection using the four self-tapping screws.

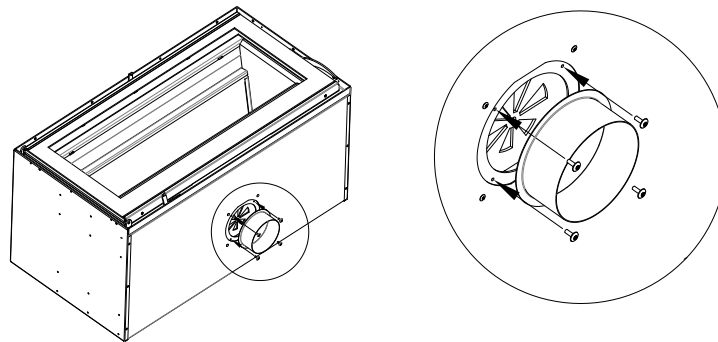

ANEXO IV: Attachment of the device to the wall and floor.

To ensure optimal stability and holding of the device, we recommend that you install the two supplied brackets

*Use the screws provided to screw the two brackets to the top of the device.
Screw the brackets to the wall using the appropriate hardware depending on the material of the same.*

Attachment of the device to the floor:

To guarantee the correct anchoring of the device to the floor, you can use the metal legs properly designed for this purpose. The choice of the appropriate hardware will be the responsibility of the installer.

ANNEX VI: TECHNICAL DETAILS

Model	DINDER 60	DINDER 70	DINDER 80
Type (according to Art.4 EN16510 standard)	CA	CA	CA
Indirect heating function	NO	NO	NO
Mass of device alone (kg)	62/84	82/149	94/164
Auxiliary electrical power consumption in standby (eISB)	0,000kW	0,00 kW	0,00 kW
Auxiliary electrical energy consumption at nominal useful power (elmax)	0,00 kW	0,00 kW	0,00 kW
General dimensions of the device (Length Y, Height Y, Width W)	784 mm x 1591 mm x 460 mm	694 mm x 1570 mm x 411 mm	694 mm x 1570 mm x 411 mm
Supply voltage (E) / Frequency (f)	230V / 50Hz	230V / 50Hz	230V / 50Hz
Maximum load that the device can support to transport the load of a smoke duct	0 kg	0 kg	0 kg
Nominal useful power (Pnom)	4.4 kW	5.5 kW	6.7 kW
Useful power at partial load (Ppart)	/	/	/
Direct partial load power (PSHpart)	/	/	/
Efficiency (η_{nom})	85%	84 %	84 %
Seasonal space heating efficiency at appliance's nominal heat output η_s	75 %	74 %	74 %
Carbon monoxide (at 13% O ₂) (CO _{nom})	728 mg/Nm ³	728 mg/Nm ³	701 mg/Nm ³
Particulate matter (PM) (PM _{nom})	2 mg/Nm ³	17 mg/Nm ³	17 mg/Nm ³
OGC (as C at 13% O ₂)	39 mg/Nm ³	58 mg/Nm ³	58 mg/Nm ³
NO _x (as NO ₂ at 13% O ₂)	108 mg/Nm ³	108 mg/Nm ³	96 mg/Nm ³
Energy efficiency index EEI	113	112	112
Energy efficiency class	A ⁺	A ⁺	A ⁺
Smoke temperature (Ta)	245 °C	301 °C	301 °C
Recommended Fuel***	25 cm (1 piece)	35cm (1 piece)	35cm (1 piece)
Fuel Load	1 piece 800 ± 10 (approx. 800 g)	1-piece 1050 ± 10 (approx. 1050 g)	1-piece 1300 ± 10 (approx. 1300g)
Type of combustion	Intermittent (INT)	Intermittent (INT)	Intermittent (INT)
Recharging intervals (Nominal useful power)	40 min	41 min	41 min
Diameter of smoke evacuation nozzle (dsh)	Ø130	Ø150	Ø150
Primary air inlet diameter	Ø80	Ø80	Ø80
Minimum draft at nominal useful power (pnom)	11.3 Pa	12 Pa	12 Pa
Outlet smoke temperature at nominal useful power (Tw - Tsnom)	245°C	301°C	301°C
Smoke mass flow at nominal useful power ($\phi_{f,g nom}$)	4,0 g/s	5,0 g/s	5,0 g/s
Ember reserve mass	50 gr	50 gr	50 gr
End of test cycle criterion	Return to the starting ember bed weight	Return to the starting ember bed weight	Return to the starting ember bed weight

Minimum clearance distances from exposed (mm)

		DINDER 60	DINDER 70	DINDER 80
Minimum clearance distances from exposed/ combustible materials (mm)	from rear wall dR	250	250	200
	from side walls dS	200	200	200
	from top dC	350	350	350
	bottom dB	50	50	50
	floor in front dF	0	0	0
	side radiation area dL	0	0	0
	from front walls dP	2000	2000	2000

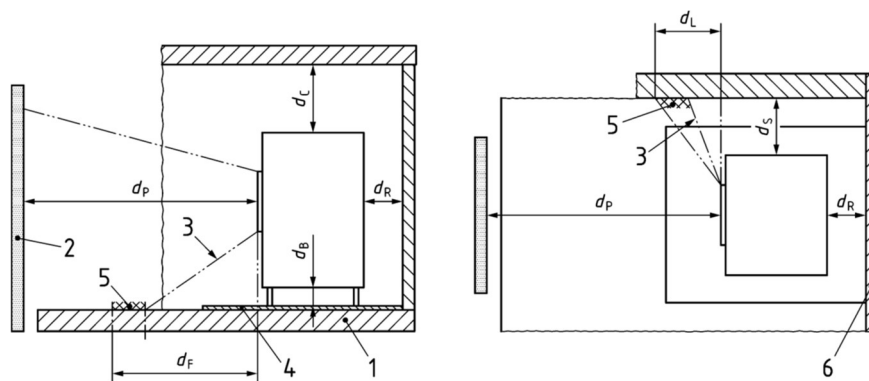

DINDER 60

Dimensions without frame.

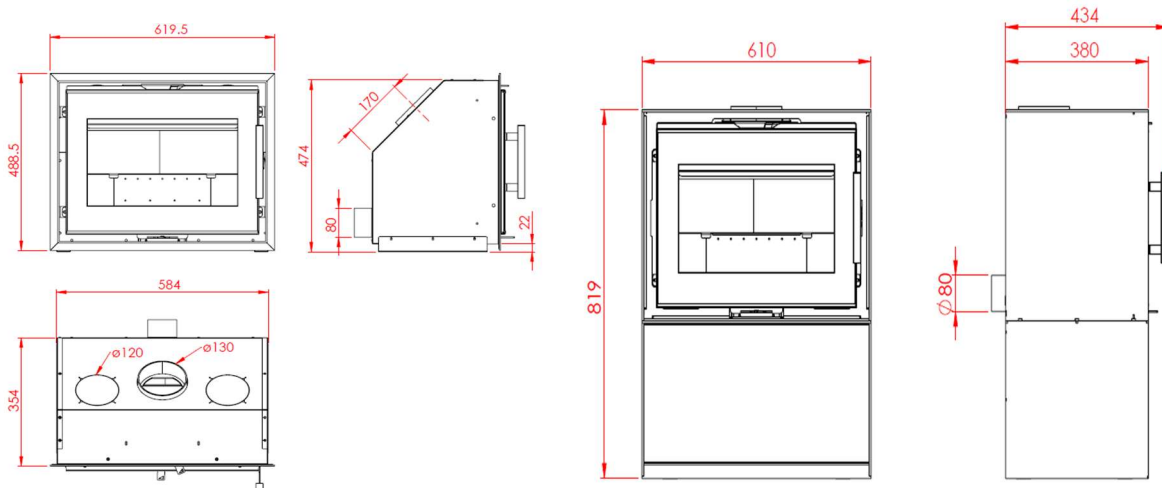

Model:	DINDER 60
Energy Efficiency Class:	A+
Energy Efficiency Index (EEI):	113
Performance:	85 %
Nominal Thermal Power:	4.4 kW
Firewood load for Nominal Power:	0,800 Kg
Reload Interval for Nominal Power:	41 min
Maximum Firewood Load:	1,2 Kg
Weight (kg):	68/84
Required Chimney Flue:	12 Pa
Average Smoke Temperature:	245°C

DINDER 70

Dimensions without frame.

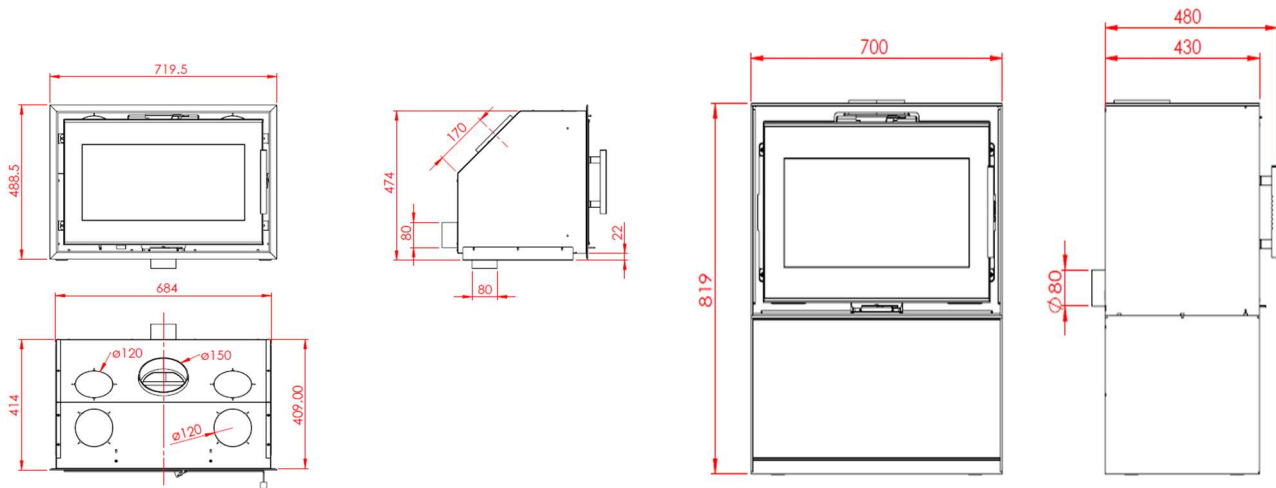

Model:	DINDER 70
Energy Efficiency Class:	A+
Energy Efficiency Index (EEI):	112
Performance:	84 %
Nominal Thermal Power:	5.5kW
Firewood load for Nominal Power:	1,0 Kg
Reload Interval for Nominal Power:	42 min
Maximum Firewood Load:	1,4 Kg
Weight:	84 kg
Required Chimney Flue:	12 Pa
Average Smoke Temperature:	301°C

DINDER 80

Dimensions without frame.

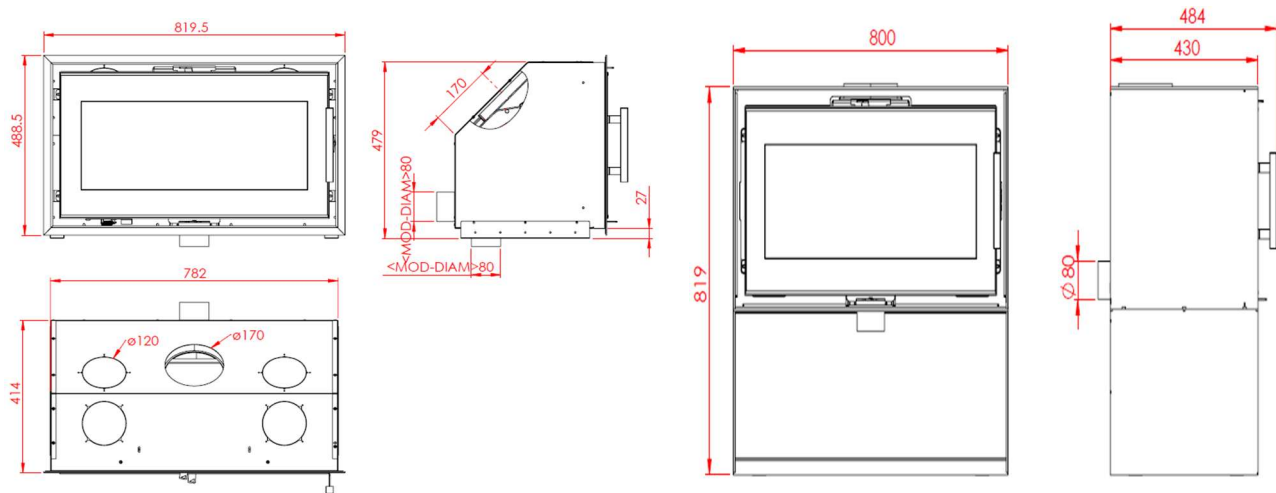

Model:	DINDER 80
Energy Efficiency Class:	A+
Energy Efficiency Index (EEI):	112
Performance:	84 %
Nominal Thermal Power:	6.7 kW
Firewood load for Nominal Power:	1,2 Kg
Nominal – Reload Interval for Nominal Power:	42 min
Maximum Firewood Load:	1,5 Kg
Weight (kg):	94 / 128
Required Chimney Flue:	12 Pa
Average Smoke Temperature:	301°C



CERTIFICACIÓN SEGÚN LA NORMA **EN 16510-1**
CERTIFICATION ACCORDING TO THE STANDARD **EN 16510-1**

EUROSTOVE LTD.- Unit 8, Oakwood Business Park - Oldmixon Cresent,BS24 9AY Weston-Super-Mare, North Somerset,UK